

This section may be constructed as a monolithic unit or built up with an asphalt filler between two asphalt curbs.

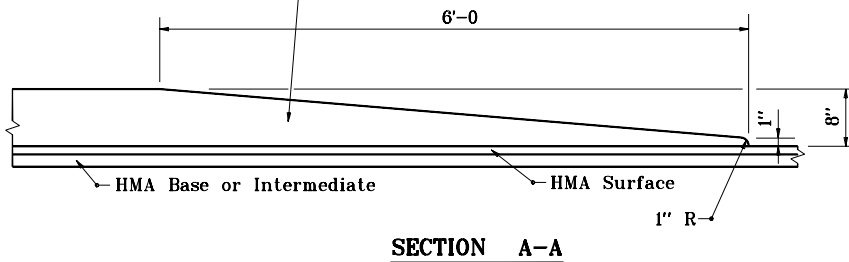

INDIANA DEPARTMENT OF TRANSPORTATION	
<b>HMA CENTER CURB</b>	
<b>TYPE A</b>	
JANUARY 2000	
<b>STANDARD DRAWING NO. E 605-CNCB-01</b>	
	<i>/s/ Anthony L. Uremovich</i> 1-03-00 <small>DESIGN STANDARDS ENGINEER      DATE</small>
	<i>/s/ Firooz Zandi</i> 1-03-00 <small>CHIEF HIGHWAY ENGINEER      DATE</small>
<small>DESIGN STANDARDS ENGINEER</small>	

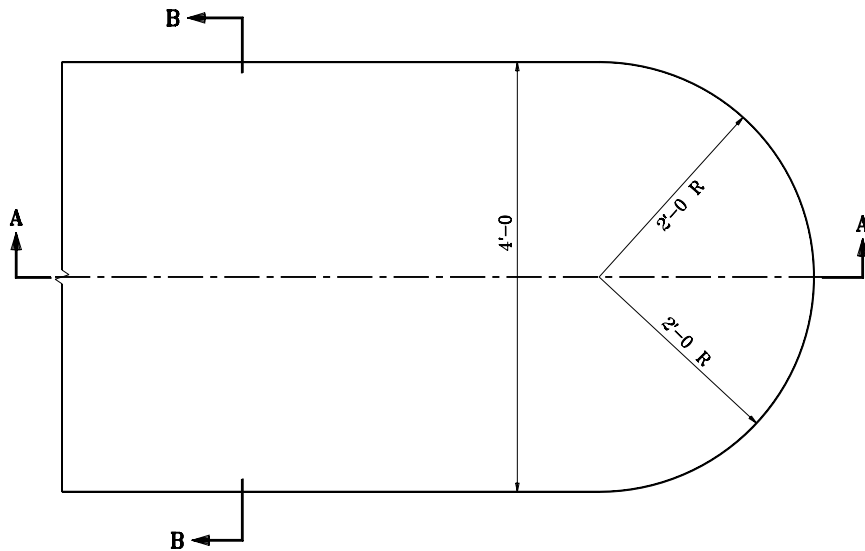
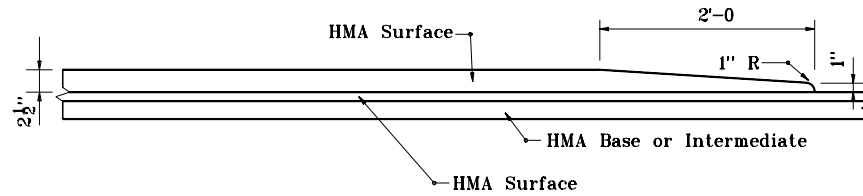
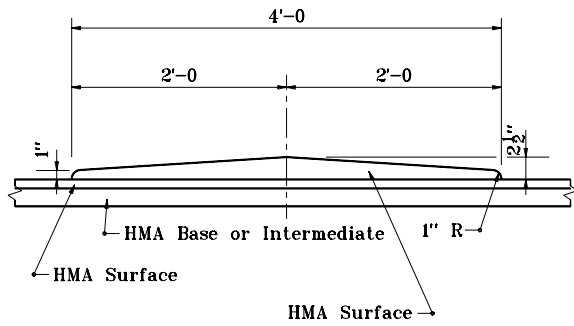

INDIANA DEPARTMENT OF TRANSPORTATION	
HMA CENTER CURB	
TYPE B	
JANUARY 2000	
STANDARD DRAWING NO. E 605-CNCB-02	
	/s/ Anthony L. Uremovich 1-03-00 DESIGN STANDARDS ENGINEER DATE
	/s/ Firooz Zandi 1-03-00 CHIEF HIGHWAY ENGINEER DATE
DESIGN STANDARDS ENGINEER	